

MODEL 432 HOZEMBLER

FEATURES:

- positive lock chuck with removable handle
- directional name plate for assembly and disassembly
- conveniently operated, moveable handwheel vise. (self centering)
- positive grip vise jaws
- permanent vise stops prevent vise from feeding into chuck
- pot chuck for regular or bent tube end nipples
- safety guard protects operator and blocks switch when opened

The 432 Hozemblem is a portable power machine to facilitate the attachment of field attachable (reusable) fittings onto Parker industrial hose. It readily handles all types from size 3 to 32, including bent tube elbows.

The unit is powered by a 1/2 horsepower, 100 to 140-volt, universal (AC or DC) motor. It is compact and portable. It mounts on its own fold-up mounting stand, or it can be bench mounted.

The momentary contact foot switch leaves both of the operator's hands free for easier and more efficient operation.

Model 432 Hozemblem.	Part No.432-115V
Complete with Hose Vise and all Adapters	
ACCESSORIES	
Fold-up Mounting Stand	Part No.662451
REPLACEMENT PARTS	
Model 432 Hose Vise.	Part No.662452
Complete with Hose Vise Jaw (Insert) Plates (662453) and Adapter (662454)	
Hose Vise Jaw Insert-Grooved -Set of 2	Part No.662453
Hose Vise Jaw Adapter.	PartNo.662454
(For use on Hose Sizes -4 (3/16") to -16 (7/811)	
Chuck Jaws -Complete set of 3	Part No.662455
Chuck Jaws Adapter set of 3	Part No.662456
(For use with most Bent Tube Ends and Hose Fitting Hex Sizes up to 1/2")	

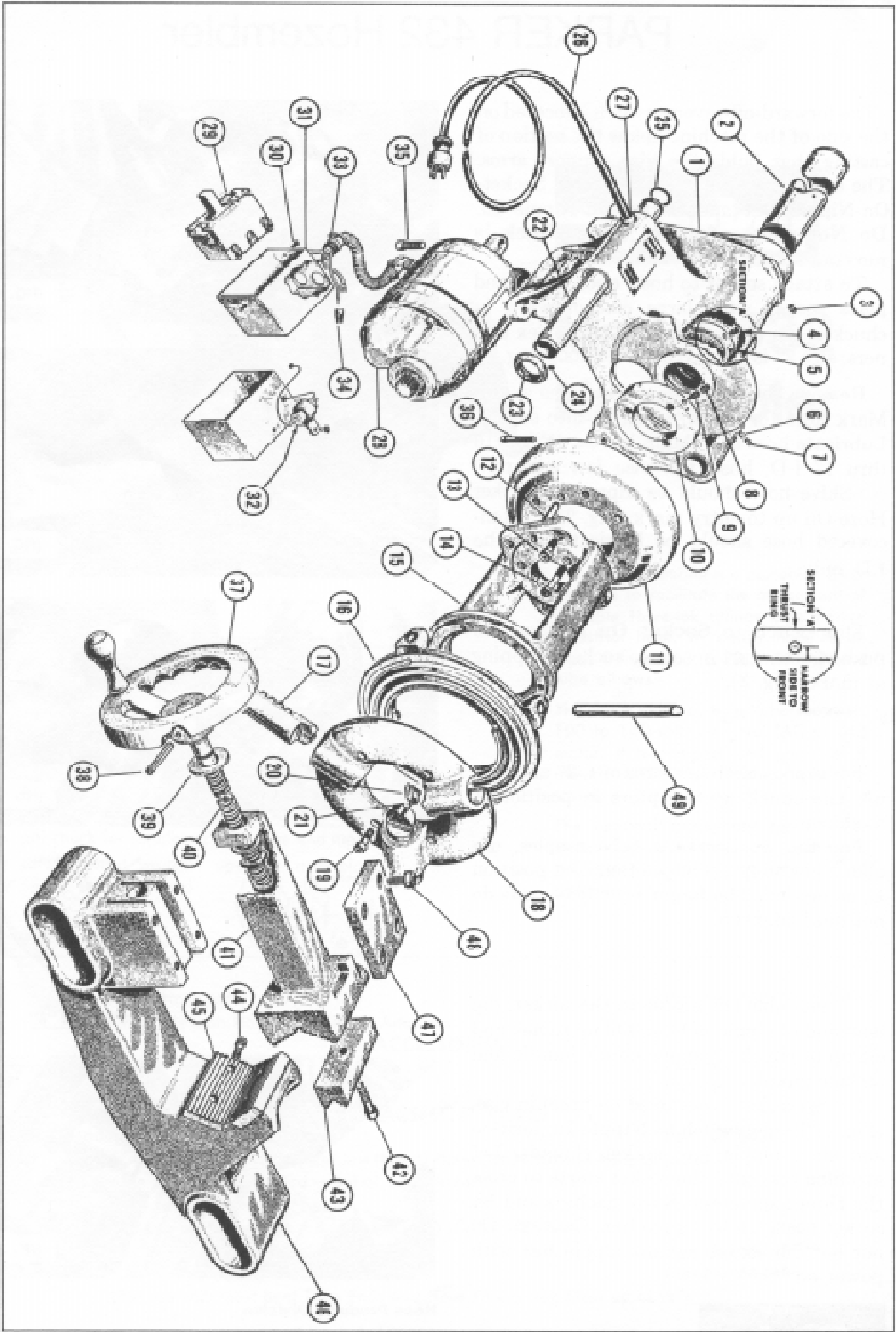

PARTS LIST

- | | | | |
|-----|--|-----|--|
| 1) | 662402 body -includes front and rear bearings
(factory installed) | 25) | 662426 spring ring (2) |
| 2) | 662403 drive shaft | 26) | 662427 service cord with plug |
| 3) | 662404 grease fitting | 27) | 662428 service cord grommet |
| 4) | 662405 5/16-24 X 3/8" dog pt. set screw (2) | 28) | 662429 motor complete |
| 5) | 662406 thrust ring (see section " A ") | 29) | 662430 switch |
| 6) | 662407 dowel pin | 30) | 662431 8-32 x 7/16" round head screw (2) |
| 7) | 662408 grease fitting | 31) | 662432 switch box |
| 8) | 662409 5/16-24 X 1/4" socket head screw | 32) | 662433 kit (for 230 volt only) includes; suppressor ,
clamp, terminals, grommet and mounting screws |
| 9) | 62410 5/16-24 x 1/2" dog point set screw | 33) | 662434 straight connector and mounting nut |
| 10) | 662411 pressure ring | 34) | 662435 wire nut |
| 11) | 662412 ring gear | 35) | 662436 3/8-16 x 1-1/4" socket head cap screw (2) |
| 12) | 662413 dowel pin | 36) | 662437 5/16-18 x 1-3/4" socket head cap screw |
| 13) | 662414 3/8-24 x 7/8" socket head cap screw (4) | 37) | 662438 hand wheel |
| 14) | 662415 5/16-18 x 2-1/4" socket head cap screw (3) | 38) | 662439 pull pin |
| 15) | 662416 chuck body support | 39) | 662440 thrust washer |
| 16) | 662417 scroll | 40) | 662441 vise screw |
| 17) | 662418 chuck jaw | 41) | 662442 jaw guide and guard assembly |
| 18) | 662419 chuck body | 42) | 662443 1/4-20 x 1-1/4" socket head cap screw |
| 19) | 662420 5/16-18 X 1-1/4" socket head cap screw (6) | 43) | 662444 jaw insert (vise jaw adapter) |
| 20) | 662421 chuck jaw adapter (3) | 44) | 662445 1/4-20 x 5/8" socket head cap screw (4) |
| 21) | 662422 6-32 x 5/8" socket head cap screw (3) | 45) | 662446 jaw insert (2) |
| 22) | 662423 support bar (2) | 46) | 662447 vise carriage |
| 23) | 662424 retaining ring assembly (4) | 47) | 662448 clamp plate |
| 24) | 662425 1/4-28 x 1/4" flat point set screw (4) | 48) | 662449 5/16-18 x 3/4" socket head cap screw (4) |
| | | 49) | chuck handle |

Operating Instructions for PARKER 432 Hozebler

The forward-off-reverse switch is located on the side of the machine below the section of casting that holds the vise support arms. The operating positions are labeled Socket- On-Nipple Out and Socket-Off-Nipple In. **Do Not reverse motor while chuck is moving.**

To attach socket to hose, open guard and place socket with large end outward in chuck (Grip all sizes except 2" on hex corners; size 2" is gripped on hex flats.) (Fig. 1).

Remove chuck handle and replace guard. Mark hose for length of entry into socket. Lubricate hose and clamp in vise. (For 3/16 thru 1" I.D. hose, use vise jaw adapter.) No-Skive hose should be dipped in Parker Hoze-Oil up to entry mark (Fig. 2). Cotton-covered hose should be lubricated on the I.D. only.

Flip switch to **Socket On** position and push vise to start hose into socket, stopping at mark (Fig. 3).

For nipples with hex sizes of 1/2" and less, use the chuck jaw adapters in position A as shown.

For the smaller bent tube nipples, use chuck jaw adapters in position A or position B, as needed. The larger bent tube ends do not need adapters.

To assemble the nipple to the socket, dip hose end of nipple in Hoze-Oil up to hex and clamp in chuck. Remove chuck handle and replace guard.

Clamp socket (assembled on hose) in vise. (Fig. 4) Throw switch to **Nipple In** position and start nipple into socket threads. Let machine run until the socket starts to cross the thread undercut. Stop machine and let socket coast up to nipple hex. Caution: Do not bottom socket against nipple hex with power on.

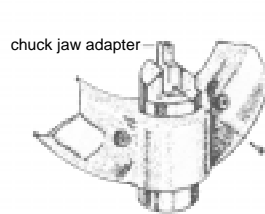
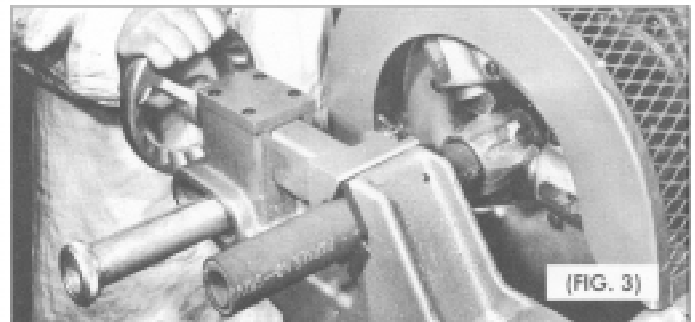
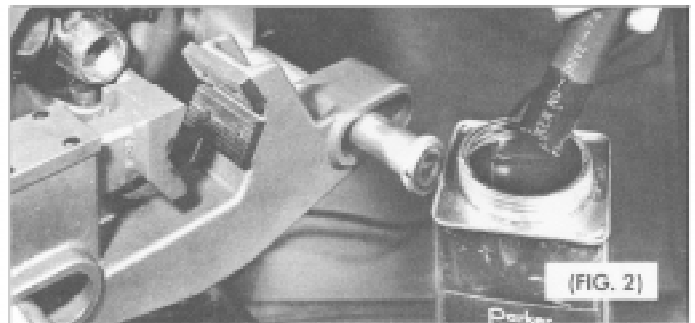
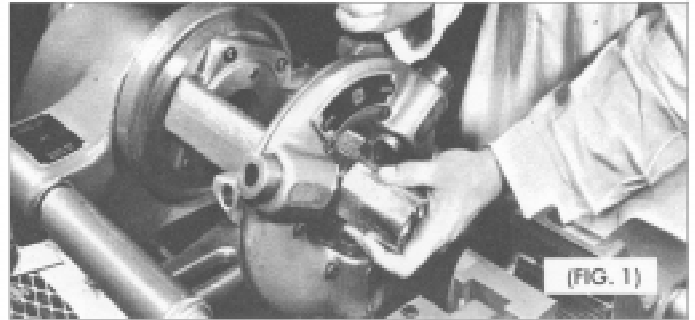

POSITION "A"

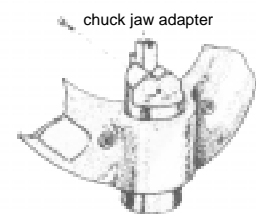

POSITION "B"

